



SERVICE BULLETIN

Date 01.07.09

Model: Elise/Exige/Europa/2-Eleven

Number:
2009/01R
Issue 2

CLASS 1

Service Manager	Service Reception	Supervisor	Parts Manager

This 'Issue 2' bulletin 2009/01R replaces the first issue dated 29.05.09, and has been extended to include all vehicles identified in S/B 2009/02. Discard S/B 2009/01R issue 1, and S/B 2009/02.

TITLE: Torque check of rear hub securing bolts on selected vehicles.

REASON: To verify that the factory torque check process has been applied.
 Lotus has identified a small range of Elise derived models where the specified torque check for the three bolts securing the rear hub bearing unit to the hub carrier, may not have been correctly performed. In any such case, there is a danger that an insecure hub could result in loss of vehicle control. Note that the driveshaft and brake disc/calliper are likely to prevent complete loss of the hub/roadwheel assembly.
 This campaign requires that all cars in a small range of affected cars are checked to confirm that all rear hub bolts are secure.

ACTION:

- Lotus is using its own sales records in conjunction with DVLA data to inform the owners of all affected vehicles that a precautionary safety recall applies, and advising them to contact their dealer to have the necessary check/rectification work carried out. A specimen letter is attached for information.
- Notwithstanding the above, dealers should immediately contact their own customers wherever possible, and arrange an early appointment.
- Dealers should immediately check any cars in their sales stock or demonstrator fleet, or any affected customer cars currently on site.

All cars in the affected VIN range (see following pages), and built in the period June 2008 to May 2009, are to be recalled for a torque check of the rear hub bolts.

Check on Warranty System that this campaign is still outstanding for the subject car.

Check Procedure

Note: The three hex. head bolts securing the hub bearing unit to the hub carrier are treated with Permabond A130 compound, and torque tightened to 90 Nm. In order to avoid breaking the adhesive bond, and the subsequent need for bolt removal, cleaning and adhesive re-application, the check procedure uses a lower torque setting in conjunction with witness marks.

1. Remove both rear roadwheels.
2. From the inboard side of the hub carrier, match mark the position of the three bolts securing the hub bearing unit to the hub carrier, by scribing a line across the head and onto the carrier.
3. Using a short torque wrench with 19mm crowsfoot adaptor ring, apply a 70 Nm tightening torque to each of the bolts in turn. If a suitable torque wrench or adaptor is not available, use a well fitting thin wall 19mm ring spanner, and apply full manual effort.
4. Examine the match marks to determine if any bolt movement has occurred;
 - if no; mark the bolt heads with white paint, and re-assemble (wheel bolt torque = 105 Nm).
 - if yes; before taking any further action, immediately inform Lotus Warranty by;
 - Telephone; +44 (0)1953 608261
 - E-mail; Warranty@LotusCars.co.uk
 - If instructed to proceed:

Continued.....

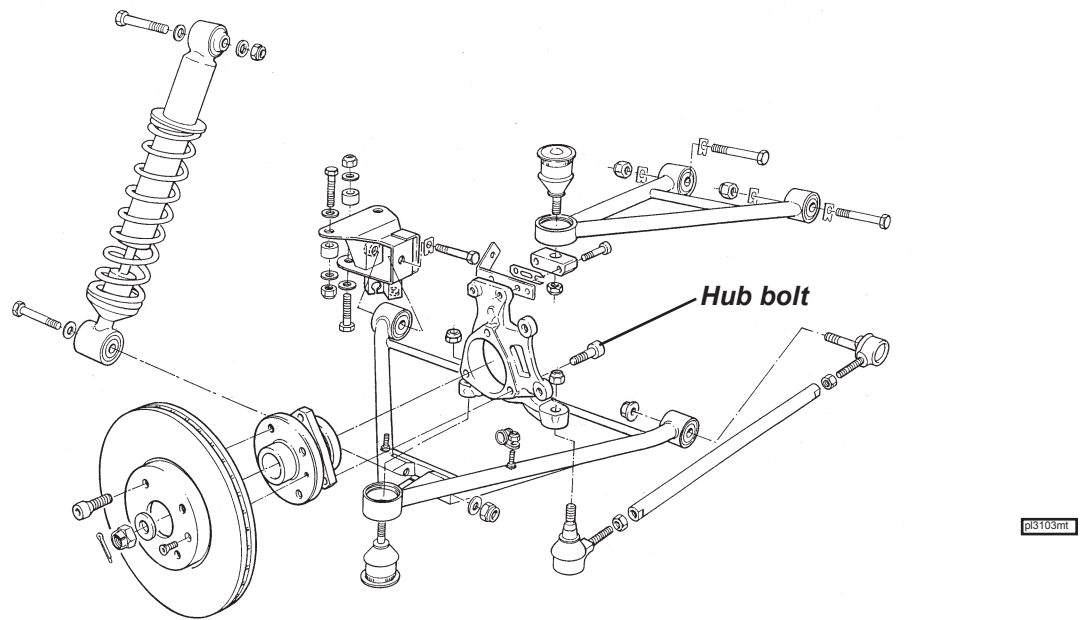

- a) Remove the hub carrier from the car -see Service Notes sub-section DH.3.
- b) Thoroughly de-grease and clean the female threads in the hub carrier. Clean the thread of each bolt using a wire brush and Acetone, apply Permabond A130 and re-install, tightening to 90 Nm.
- c) Mark the hub bolt heads with white paint.
- d) Reassemble the suspension - see Service Notes sub-section DH.3.
- e) Refit the roadwheels - wheel bolt torque = 105 Nm.

CHARGES: 1. For the torque check, submit claims via the DC603 bulk campaigns screen. The campaign number is 2009/01R. The times allocated for the torque check are 0.4 hours against operation code 31039000. There should be no need to enter inspection type. Claims for the torque check will automatically be paid and not subject to the normal payment approval procedure.

2. If, following the torque check, any repair is required, contact Customer Services immediately and do not proceed until instructed to do so;
Tel: +44 (0)1953 608844
e-mail: customerservices@lotuscars.co.uk

3. Warranty claims for any authorised repair should be made using the normal warranty claim entry screen, DC602, using the following Position/Operation Codes:-
31039101 Left hand hub retorque 1.6 hours
31039201 Right hand hub retorque 1.6 hours
These will be subject to the normal payment approval procedure.

Note: All claims against S/B 2009/01R and 2009/02 already submitted will be honoured - take no further action.

United Kingdom

2008 model year

SCCNA12348HF21639
 SCCWC11128HN81706
 SCCCA12328HF21730
 SCCSC12198HN11746
 SCCWC11128HN81754
 SCCWC11178HN81796
 SCCPC11168HN31802
 SCCZC11158HN31816
 SCCWC11128HN81821
 SCCYC11138HC31822
 SCCWC11168HN81823
 SCCVC11168HC81827
 SCCWC11138HN81830
 SCCYC11178HN31831
 SCCZC11128HN31837
 SCCWC11188HN81838
 SCCYC11178HN31845
 SCCZC11128HC31847
 SCCWC11128HN81849
 SCCWC11108HN81851
 SCCWC11128HN81852
 SCCWC11148HN81853
 SCCPC11138HN31854
 SCCZC11198HD31864
 SCCPC111X8HP31887
 SCCPC11168HN31895
 SCCNA12308HG21897
 SCCYC11158HN31911
 SCCYC11128HD31913
 SCCZC11178HN31915
 SCCYC11168HN31920
 SCCWC11118HN81924
 SCCPC11158HC31929
 SCCZC11138HN31930
 SCCYC11168HN31948
 SCCZC11148HN31953
 SCCYC11118HN31954
 SCCZC11148HN31967
 SCCYC11138HC31982
 SCCZC11128HN31983
 SCCZC11148HN31984
 SCCVC11158HN81985
 SCCZC11188HN31986
 SCCZC111X8HN31987
 SCCZC11118HN31991
 SCCWC11178HN81992
 SCCWC11198HN81993
 SCCYC11148HP31999
 SCCWC11108HN82000
 SCCZC11198HN32001
 SCCVC11118HN82003
 SCCZC11148HN32004
 SCCYC111X8HC32014
 SCCAA11128HP82022
 SCCVC11148HN82027
 SCCZC11178HN32031
 SCCYC11168HN32033
 SCCVC11138HN82035

SCCPC11198HN32037
 SCCWC11138HN82038
 SCCZC11118HN32039
 SCCZC11138HN32043
 SCCZC11198HN32046
 SCCZC11108HN32050
 SCCWC11168HN82051
 SCCYC111X8HN32052
 SCCZC11188HN32054
 SCCNA12398HF22057
 SCCNA12308HF22058
 SCCPC11188HN32059
 SCCZC11138HN32060
 SCCZC11158HN32061
 SCCWC11108HN82062
 SCCPC111X8HN32063
 SCCZC11108HN32064
 SCCYC11188HN32065
 SCCWC11188HN82066
 SCCZC111X8HN32069
 SCCWC11118HN82071
 SCCZC11118HN32073
 SCCZC11128HN32082
 SCCZC11148HN32083
 SCCYC11118HN32084
 SCCZC11188HN32085
 SCCWC11178HN82088
 SCCWC11178HN82091
 SCCNA12398HJ22092
 SCCPC11118HN32095
 SCCZC11148HN32097
 SCCNA12318HF22098
 SCCAA11118HN82099
 SCCZC11128HN32101
 SCCWC111X8HN82103
 SCCWC11158HN82106
 SCCWC11178HN82107
 SCCZC11158HN32111
 SCCZC11148HN32116
 SCCYC11138HN32118
 SCCWC111X8HN82120
 SCCZC11118HN32123
 SCCZC11138HN32124
 SCCPC11168HN32125
 SCCWC11128HN82127
 SCCYC11168HN32128
 SCCZC11128HN32129
 SCCZC11148HN32133
 SCCPC11198HN32135
 SCCZC11178HN32143
 SCCYC11148HN32144
 SCCPC11198HN32149
 SCCWC11188HN82150
 SCCWC11198HN82156
 SCCZC11138HN32169
 SCCYC11178HN32171
 SCCYC11188HN32177
 SCCZC11178HD32186
 SCCWC11168HN82194
 SCCZC11188HN32197
 SCCDC12128HP12199

SCCZC11168HN32201
 SCCZC11188HN32202
 SCCYC11128HC32203
 SCCZC11198HN32208
 SCCDC12198HN12209
 SCCWC11168HN82213
 SCCPC11198HN32216
 SCCWC11158HN82218
 SCCYC11198HN32219
 SCCYC11158HN32220
 SCCZC11108HN32226
 SCCWC11188HN82228
 SCCNA123X8HF22231
 SCCZC111X8HD32232
 SCCPC11198HN32233
 SCCWC11138HN82234
 SCCZC11148HP32235
 SCCWC11128HN82239
 SCCWC11108HN82241
 SCCZC11198HN32242
 SCCPC11108HC32244
 SCCWC11198HN82254
 SCCPC11118HN32257
 SCCYC11118HN32263
 SCCPC11198HN32264
 SCCPC11188HC32265
 SCCYC11138HC32274
 SCCWC11138HN82282
 SCCPC11148HN32284
 SCCZC11178HN32286
 SCCYC11148HN32287
 SCCYC11168HN32288
 SCCWC11158HN82297
 SCCZC11188HP32299
 SCCHC12108HP1MD02
 SCCHC12108HP1MD03

2009 Model Year

SCCAA11149HP80001
 SCCNA12309HF20022
 SCCPC11179HN30031
 SCCWC11169HN80043
 SCCPC11159HP30051
 SCCVC11109HN80065
 SCCZC11189HP30067
 SCCWC11159HP80069
 SCCPC11109HP30071
 SCCZC11149HN30075
 SCCPC11199HN30077
 SCCVC11169HC80078
 SCCPC11129HN30079
 SCCPC11199HN30080
 SCCYC11159HN30081
 SCCYC11179HN30082
 SCCPC11149HN30083
 SCCYC11169HN30087
 SCCYC11189HN30088
 SCCYC111X9HN30089
 SCCVC11199HN80095
 SCCYC11169HC30102
 SCCDC12179HN10105

SCCDC121X9HN10115
 SCCVC111X9HN80123
 SCCWC11189HN80125
 SCCZC11129HN30155
 SCCYC11159HN30159
 SCCNA12359HG20164
 SCCNA12399HH20168
 SCCPC11179HC30170
 SCCPC111X9HN30184
 SCCPC11149HN30195
 SCCWC11199HN80196
 SCCPC11189HN30202
 SCCSC12199HN10209
 SCCDC12199HP10211
 SCCWC11179HN80214
 SCCZC11159HN30215
 SCCAA11179HP80249
 SCCDC12119HN10276
 SCCZC111X9HD30286
 SCCYC11149HC30292
 SCCWC11179HN80293
 SCCYC111X9HN30299
 SCCAC11109HC80303
 SCCYC11189HN30334
 SCCZC11139HN30343
 SCCWC11159HN80373
 SCCYC11109HN30375
 SCCNA12379HH20377
 SCCNA12389HG20403
 SCCCA12379HH20404
 SCCCA12399HH20405
 SCCYA11179HC30406
 SCCZC11159HN30408
 SCCPC11189HN30409
 SCCSC12169HP10416
 SCCVC11109HN80437
 SCCVC11149HN80439
 SCCVC11129HN80441
 SCCVC11189HN80444
 SCCVC11139HN80447
 SCCVC11179HN80452
 SCCVC11129HN80455
 SCCVC11169HN80460
 SCCYC11179HP30461
 SCCVC11109HN80471
 SCCNA12349HG20477
 SCCWC111X9HN80479
 SCCAC11169HN80490
 SCCDC12149HN10515
 SCCZC11159HC30516
 SCCYC11189HP30520
 SCCNA12339HG20521
 SCCAA11159HP80525
 SCCCA12329HF20529
 SCCYC11179HD30533
 SCCNA12379HJ20536
 SCCWC11159HP80542
 SCCWC11119HN80550
 SCCYC11199HD30551
 SCCYC11199HP30557
 SCCVC11149HP80558

SCCZC11199HP30563
 SCCYC11169HP30564
 SCCZC11189HP30568
 SCCWC11149HN80574
 SCCPC11139HN30575
 SCCYC11159HN30579
 SCCYC11189HP30582
 SCCYC11109HD30583
 SCCYC11129HD30584
 SCCYC11179HP30590
 SCCYC11129HP30593
 SCCZC11189HN30595
 SCCAC11149HP80607
 SCCPC11149HP30610
 SCCYC11119HD30611
 SCCNA123X9HG20614
 SCCNA12319HH20620
 SCCYC11109HP30625
 SCCNA123X9HF20626
 SCCYC11199HD30629
 SCCZC11109HP30631
 SCCYC11109HD30633
 SCCSC12129HP10641
 SCCPC11109HD30644
 SCCYC11169HP30645
 SCCZC11199HD30666
 SCCAC111X9HN80668
 SCCNA12329HG20669
 SCCZC11139HP30672
 SCCAA11159HP80685
 SCCYC11149HP30689
 SCCVC11179HP80733
 SCCAA11139HP80734
 SCCVC11179HP80750

2010 model year

SCCZC1111AHD30004
 SCCWC1119AHN80011
 SCCYC1118AHD30013
 SCCWC1112AHP80017
 SCCPC1118AHD30024
 SCCPC1112AHC30033
 SCCNA1231AHJ20035
 SCCVC1115AHP80038
 SCCPC111XAHP30051
 SCCZC1113AHD30053
 SCCYC1117AHP30061
 SCCZC1112AHN30063
 SCCZC1116AHD30077
 SCCZC1112AHP30084
 SCCZC1119AHD30090

Europe

2008 model year

SCCAA11118HP81573
 SCCAA11118HP81637
 SCCZC11168HP31684
 SCCZC11188HP31685
 SCCWC11138HP81686
 SCCZC11198HP31694
 SCCWC11148HP81695
 SCCZC11158HP31708
 SCCZC11178HP31712
 SCCNA12358HG21779
 SCCPC11128HD31793
 SCCZC11148HP31814
 SCCZC11198HP31825
 SCCZC11168HP31829
 SCCZC11168HP31832
 SCCZC11198HD31833
 SCCZC111X8HP31834
 SCCZC11118HP31835
 SCCPC11108HD31842
 SCCZC11188HP31850
 SCCWC11108HP81855
 SCCPC11108HD31856
 SCCNA123X8HG21857
 SCCVC11158HP81863
 SCCVC11128HP81867
 SCCPC11198HD31872
 SCCNA12398HG21879
 SCCNA12398HG21882
 SCCPC11128HD31888
 SCCVC11128HD81889
 SCCZC11198HP31890
 SCCZC11128HP31892
 SCCWC11188HP81893
 SCCZC111X8HP31896
 SCCZC11138HP31898
 SCCPC11188HN31901
 SCCZC11138HP31903
 SCCPC11188HP31905
 SCCVC11188HP81906
 SCCVC11138HP81912
 SCCZC11168HD31918
 SCCWC11108HP81919
 SCCZC11158HD31926
 SCCYC11118HP31927
 SCCYC11148HD31931
 SCCNA12328HG21934
 SCCYC11108HP31949
 SCCYC11108HP31952
 SCCAA111X8HD81966
 SCCZC11108HP31969
 SCCPC11108HD31971
 SCCWC11138HP81977
 SCCAA11158HP81981
 SCCAA11168HP81990
 SCCZC11148HD31996
 SCCZC11148HD32002
 SCCNA12388HG22005
 SCCAA111X8HP82009

SCCZC11138HD32010
 SCCYC111X8HD32016
 SCCWC11148HP82023
 SCCPC11138HD32029
 SCCYC11108HP32034
 SCCPC11128HD32040
 SCCWC11168HP82041
 SCCZC11188HP32044
 SCCZC11138HP32047
 SCCZC11178HP32049
 SCCAA11168HP82055
 SCCAA11128HP82067
 SCCZC11108HP32068
 SCCWC11118HP82075
 SCCZC11118HP32077
 SCCWC11178HP82078
 SCCAA11198HP82079
 SCCAA11188HP82090
 SCCZC11118HP32094
 SCCPC11198HD32102
 SCCPC11198HP32108
 SCCZC111X8HP32109
 SCCWC11168HD82113
 SCCAA11188HD82114
 SCCYC11118HD32115
 SCCWC11128HP82117
 SCCZC11128HP32119
 SCCZC111X8HP32126
 SCCYC11178HP32130
 SCCZC11128HP32136
 SCCYC11198HP32145
 SCCWC11128HP82151
 SCCWC11178HP82159
 SCCZC11138HP32162
 SCCZC11168HD32163
 SCCDC12158HP12164
 SCCYC11148HP32165
 SCCZC11108HP32166
 SCCPC11138HP32167
 SCCAA11188HP82168
 SCCZC11128HP32170
 SCCNA12308HG22175
 SCCDC12118HP12176
 SCCZC11178HP32178
 SCCYC11148HP32179
 SCCAA11198HP82180
 SCCWC11108HP82181
 SCCPC11198HP32187
 SCCZC11108HD32188
 SCCWC11138HP82191
 SCCDC12118HP12193
 SCCPC111X8HP32196
 SCCWC11168HP82198
 SCCWC11188HP82204
 SCCZC11178HD32205
 SCCWC11138HP82210
 SCCPC11158HD32212
 SCCYC11188HP32217
 SCCAA11118HP82223
 SCCWC11138HP82224
 SCCZC11198HP32229

SCCWC111X8HD82230
 SCCWC111X8HP82236
 SCCZC11188HP32237
 SCCZC11198HD32240
 SCCZC11138HP32243
 SCCWC11108HP82245
 SCCNA12368HH22247
 SCCZC11128HP32248
 SCCWC11188HP82249
 SCCZC11108HP32250
 SCCPC11148HD32251
 SCCZC11148HP32252
 SCCYC11118HD32258
 SCCNA12388HJ22259
 SCCZC11138HP32260
 SCCYC11108HP32261
 SCCAA11108HP82262
 SCCZC11148HP32266
 SCCDC12168HP12268
 SCCPC11108HP32269
 SCCZC111X8HP32272
 SCCNA12308HG22273
 SCCZC11158HP32275
 SCCYC11138HD32276
 SCCZC11128HP32279
 SCCZC11108HP32281
 SCCSC12138HP12283
 SCCZC11188HP32285
 SCCZC11118HP32290
 SCCYC11198HP32291
 SCCZC11178HP32293
 SCCZC11108HP32295
 SCCZC11138HD32296
 SCCYC11128HD32298
 SCCYC11198HD32301

2009 model year

SCCZC11119HP30007
 SCCCA12339HG20008
 SCCZC11139HP30011
 SCCZC11179HP30013
 SCCPC11119HP30015
 SCCZC11189HP30019
 SCCYC11109HD30020
 SCCYC11129HD30021
 SCCZC11179HP30027
 SCCYC11129HP30030
 SCCZC11109HP30032
 SCCCA12329HG20033
 SCCYC11129HD30035
 SCCZC11109HD30037
 SCCYC11189HD30038
 SCCCA12339HG20039
 SCCZC111X9HP30040
 SCCZC111X9HD30045
 SCCZC11129HP30050
 SCCZC111X9HP30054
 SCCPC11139HD30055
 SCCZC11109HP30063
 SCCZC111X9HP30068
 SCCZC11119HP30072

SCCZC11199HP30076 SCCAA11159HD80421
 SCCYC11159HP30085 SCCZC111X9HD30434
 SCCYC11119HD30091 SCCAA11169HP80436
 SCCDC12159HP10092 SCCAA11119HP80442
 SCCZC11199HP30093 SCCZC11139HP30445
 SCCZC11189HP30103 SCCAA11129HP80448
 SCCZC111X9HP30104 SCCVC11169HP80450
 SCCWC11199HP80107 SCCAA11199HD80454
 SCCDC121X9HP10119 SCCZC11149HP30468
 SCCYC11139HD30156 SCCDC12189HP10474
 SCCYC111X9HP30163 SCCAA11149HD80488
 SCCYC11169HD30166 SCCAA11169HD80489
 SCCWC11179HP80171 SCCYC11189HD30492
 SCCVC11149HP80172 SCCZC11159HP30494
 SCCZC11179HP30173 SCCWC11109HP80495
 SCCPC11119HP30189 SCCZC11199HP30496
 SCCPC11199HD30206 SCCNA123X9HG20497
 SCCZC11199HP30207 SCCYC11199HD30498
 SCCDC121X9HP10220 SCCAA11189HP80499
 SCCDC12119HP10221 SCCYC11179HD30502
 SCCZC11149HD30235 SCCZC11139HD30503
 SCCZC11189HD30240 SCCWC11189HP80504
 SCCZC11119HD30242 SCCZC11169HP30505
 SCCPC11129HP30265 SCCWC11119HP80506
 SCCYC11179HD30273 SCCNA12399HG20507
 SCCYC111X9HP30275 SCCWC11179HP80509
 SCCYC11159HP30278 SCCZC111X9HP30510
 SCCYC11139HD30285 SCCZC11119HP30511
 SCCYC11199HD30288 SCCNA12329HG20512
 SCCZC11149HP30289 SCCYC11109HP30513
 SCCYC11179HD30290 SCCYC11129HP30514
 SCCZC11129HP30291 SCCYC11199HD30517
 SCCDC12189HP10300 SCCNA12339HG20518
 SCCDC12159HP10304 SCCYC11119HP30522
 SCCPC11109HD30305 SCCZC11199HD30523
 SCCZC11119HD30306 SCCYC11159HP30524
 SCCYC11199HD30307 SCCYC11199HP30526
 SCCAA11189HP80308 SCCDC12139HP10527
 SCCZC11159HD30311 SCCZC11179HP30528
 SCCVC11109HD80323 SCCYC11109HP30530
 SCCZC11119HP30329 SCCZC111X9HD30532
 SCCAA11119HP80330 SCCYC11189HP30534
 SCCAA11139HP80331 SCCWC11139HP80538
 SCCYC11129HP30335 SCCYC11189HD30539
 SCCYC11149HP30336 SCCAA11139HP80541
 SCCAA11149HP80340 SCCAA11179HP80543
 SCCAA11169HP80341 SCCAA11199HP80544
 SCCAA11189HP80342 SCCAA11169HP80548
 SCCYC11149HD30344 SCCSC12139HP10552
 SCCZC11109HD30345 SCCAA11119HP80554
 SCCDC121X9HP10346 SCCYC11139HD30559
 SCCAA11169HP80355 SCCAA11199HP80561
 SCCPC11149HD30372 SCCAA11109HP80562
 SCCZC111X9HP30376 SCCAA11129HP80577
 SCCAA11149HP80399 SCCAA11149HP80578
 SCCAA11119HD80402 SCCAA11159HP80587
 SCCDC12149HP10407 SCCAA11149HP80600
 SCCYC11129HD30410 SCCAA11179HD80601
 SCCZC11189HP30411 SCCAA11189HP80602
 SCCYC11159HD30417 SCCAA11109HP80609
 SCCDC12109HP10419 SCCPC11149HP30624

SCCYC11149HP30630
 SCCAA11169HP80632
 SCCAA111X9HP80634
 SCCAA111X9HD80642
 SCCYC11179HP30654
 SCCAA11179HP80655
 SCCPC11189HP30660
 SCCZC11199HP30661
 SCCZC11169HP30665
 SCCDC12189HP10670
 SCCAA11129HP80675
 SCCYC11189HP30677
 SCCZC11149HP30678
 SCCNA12359HG20679
 SCCAA111X9HP80682
 SCCZC11179HP30688

2010 model year

SCCVC1115AHD80001
 SCCYC1115AHD30003
 SCCYC1119AHD30005
 SCCNA1235AHG20007
 SCCWC1113AHP80009
 SCCZC1117AHD30010
 SCCNA1232AHG20014
 SCCPC1118AHP30016
 SCCVC1111AHP80022
 SCCWC1117AHP80031
 SCCZC1111AHP30044
 SCCPC1115AHD30045
 SCCZC1117AHP30047
 SCCZC1118AHD30050
 SCCZC1118AHD30064
 SCCPC1110AHD30065
 SCCZC1111AHD30066
 SCCYC1116AHD30074
 SCCZC1111AHP30075
 SCCYC1113AHD30081
 SCCPC1115AHP30085

Rest of World

2008 model year

SCCSC12138HN11595
 SCCZC11108HP31678
 SCCPC11128HP31687
 SCCWC111X8HP81720
 SCCYC11198HN31815
 SCCZC11118HP31818
 SCCYC111X8HN31824
 SCCYC11138HN31826
 SCCWC11188HN81841
 SCCWC11148HN81870
 SCCPC11148HN31877
 SCCNA12338HH21878
 SCCZC11198HN31883
 SCCZC11108HN31884
 SCCPC11138HN31885
 SCCZC11138HN31894
 SCCWC11168HN81899
 SCCZC11198HN31902
 SCCWC11118HN81910
 SCCYC11108HN31914
 SCCYC11168HN31917
 SCCZC11128HN31921
 SCCYC11118HN31923
 SCCYC11158HN31925
 SCCZC11158HN31928
 SCCWC111X8HN81937
 SCCYC11138HN31938
 SCCYC11118HN31940
 SCCWC11138HN81942
 SCCYC11178HN31943
 SCCYC11198HN31944
 SCCWC11128HN81947
 SCCYC11138HN31955
 SCCWC11138HN81956
 SCCYC11198HN31958
 SCCYC11108HN31959
 SCCZC11118HN31960
 SCCYC11198HN31961
 SCCVC11148HN81962
 SCCYC11128HN31963
 SCCZC11108HN31965
 SCCYC11118HN31968
 SCCYC11178HN31974
 SCCZC11138HN31975
 SCCPC111X8HN31978
 SCCYC11168HN31979
 SCCYC11178HN31988
 SCCZC11138HN31989
 SCCYC11128HN31994
 SCCZC11128HN31997
 SCCYC11178HN32011
 SCCZC11168HP32012
 SCCWC11188HN82018
 SCCZC11198HP32019
 SCCYC11188HN32020
 SCCZC111X8HN32024
 SCCYC11198HN32026
 SCCVC11178HP82030

SCCAA111X8HN82036	SCCYC11119HN30028	SCCAC11189HN80264	SCCYC11189HN30396
SCCYC11178HN32042	SCCWC11119HN80029	SCCVC11159HN80269	SCCYC111X9HN30397
SCCAA11108HN82045	SCCPC11129HN30034	SCCYC111X9HN30271	SCCYC11119HN30398
SCCPC11168HP32048	SCCPC111X9HN30041	SCCWC11129HP80272	SCCAC11119HN80400
SCCWC111X8HN82053	SCCPC11199HN30046	SCCDC12139HN10280	SCCAA111X9HN80420
SCCYC11118HN32070	SCCPC11139HP30047	SCCCA12319HJ20281	SCCZC11149HP30485
SCCPC11108HN32072	SCCPC11129HN30048	SCCCA12339HJ20282	SCCYC11109HN30537
SCCYC11198HN32074	SCCWC11179HN80049	SCCCA12359HJ20283	SCCYC11109HN30540
SCCYC11128HN32076	SCCPC11149HN30052	SCCWC11169HN80284	SCCWC11159HN80566
SCCYC11148HN32080	SCCWC11199HN80053	SCCWC11109HN80295	SCCYC11109HN30571
SCCYC11168HN32081	SCCPC11119HN30056	SCCWC11149HN80297	SCCWC11149HN80588
SCCYC11158HN32086	SCCPC11139HN30057	SCCCA12359HJ20302	SCCAA11169HP80615
SCCYC11178HN32087	SCCWC11189HN80058	SCCYC11199HN30309	SCCZC11119HE30616
SCCYC11108HN32089	SCCWC11169HN80060	SCCZC111X9HN30310	SCCYC11199HN30617
SCCYC11168HN32100	SCCYC11179HN30096	SCCZC11159HN30313	SCCWC11199HN80618
SCCPC11178HP32110	SCCYC11199HN30097	SCCYC11129HN30314	SCCYC11129HN30619
SCCYC11158HN32122	SCCCA12319HF20098	SCCYC11189HN30317	SCCDC12139HN10621
SCCYC11188HN32132	SCCYC11129HN30099	SCCWC11169HN80320	SCCAA11139HP80622
SCCYC11178HN32137	SCCWC11139HN80100	SCCYC11119HN30322	SCCZC11199HE30623
SCCWC11168HN82146	SCCCA12379HF20106	SCCYC11129HN30328	SCCWC111X9HE80627
SCCYC111X8HN32147	SCCYC11119HN30109	SCCDC12179HN10332	SCCAA11149HP80628
SCCZC11188HN32152	SCCWC11169HN80110	SCCDC12199HN10333	SCCYC11149HN30640
SCCZC111X8HN32153	SCCYC111X9HN30111	SCCCA12369HJ20339	SCCYC111X9HN30643
SCCYC11178HN32154	SCCYC11139HN30113	SCCCA12379HJ20348	SCCAA11169HP80646
SCCPC11188HN32157	SCCCA123X9HF20116	SCCDC12129HN10349	SCCAA11169HP80663
SCCYC11198HN32172	SCCYC11109HN30117	SCCCA12359HJ20350	SCCYC11149HN30671
SCCWC11198HN82173	SCCYC11129HN30118	SCCCA12379HJ20351	SCCAA11149HN80686
SCCWC11108HN82174	SCCCA12319HF20120	SCCCA12399HJ20352	SCCAA11169HN80687
SCCYC11118HN32182	SCCYC11129HN30121	SCCCA12309HJ20353	SCCAA11169HN80690
SCCPC11198HN32183	SCCCA12349HF20127	SCCAA11109HH80354	SCCAA11179HN80696
SCCYC11148HN32192	SCCYC11109HN30134	SCCCA12369HJ20356	SCCAA11109HN80698
SCCNA12388HJ22195	SCCYC11149HN30136	SCCCA12389HJ20357	SCCAA11159HN80700
SCCYC11128HN32207	SCCZC11149HN30139	SCCCA123X9HJ20358	SCCAA111X9HN80711
SCCYC11178HP32211	SCCYC11149HN30153	SCCCA12319HJ20359	SCCAA11139HN80713
SCCYC111X8HN32214	SCCYC11119HN30157	SCCCA12389HJ20360	SCCAA11109HN80720
SCCYC11198HN32222	SCCAC11179HN80160	SCCAA11189HH80361	SCCAA11159HN80728
SCCZC11198HN32225	SCCYC11139HN30161	SCCAA111X9HH80362	SCCAA11179HC80739
SCCYC11188HN32227	SCCYC11109HN30165	SCCAA11119HH80363	
SCCZC11168HN32246	SCCAC111X9HN80167	SCCAA11139HH80364	<i>2010 model year</i>
SCCVC11128HN82253	SCCAC11109HN80176	SCCAA11159HH80365	SCCYC1117AHN30006
SCCYC11148HN32256	SCCWC11179HN80178	SCCAA11199HH80367	SCCYC1112AHN30012
SCCYC11198HN32270	SCCZC11139HN30181	SCCAA11109HH80368	SCCYC1118AHN30015
SCCYC11108HN32271	SCCVC11119HN80186	SCCAA11129HH80369	SCCYC1114AHN30027
SCCWC11168HN82289	SCCPC11199HN30192	SCCAA11199HH80370	SCCPC1114AHN30041
SCCNA12368HJ22292	SCCYC11179HN30194	SCCAA11109HH80371	SCCPC1118AHN30043
SCCWC11118HN82300	SCCZC111X9HN30212	SCCZC11169HP30374	SCCPC1116AHD30054
SCCWC11198HN82304	SCCZC11179HN30216	SCCZC11109HE30378	SCCPC1114AHN30055
SCCZC111X8HP32305	SCCPA12339HF20217	SCCZC11199HE30380	SCCYC1119AHN30072
SCCZC11198HN32306	SCCWC11169HN80219	SCCZC11129HE30382	SCCZC1110AHN30076
	SCCPC11159HN30223	SCCWC11189HE80383	SCCWC1111AHN80083
<i>2009 model year</i>	SCCWC11119HN80225	SCCZC11169HE30384	
SCCYC11159HN30002	SCCPC11109HN30226	SCCWC11119HE80385	
SCCYC11179HN30003	SCCZC11119HN30227	SCCWC11139HE80386	
SCCWC11179HN80004	SCCPA123X9HF20229	SCCWC11179HE80388	
SCCYC11129HN30006	SCCZC11139HN30231	SCCWC11199HE80389	
SCCWC11129HN80010	SCCWC11109HN80233	SCCYC11179HN30390	
SCCPC11129HN30017	SCCDC12179HN10248	SCCYC11199HN30391	
SCCYC11199HN30018	SCCPA12329HF20256	SCCYC11109HN30392	
SCCYC11129HN30023	SCCDC121X9HN10261	SCCYC11129HN30393	
SCCWC11129HN80024	SCCDC12119HN10262	SCCYC11149HN30394	
SCCYC11169HN30025	SCCPA123X9HF20263	SCCYC11169HN30395	

Mr/Ms. A.N. Other,
1 The Street,
Anytown,
Anycountry.
AB12 3CD

May 2009

CODE OF PRACTICE VEHICLE SAFETY RECALL - LOTUS ELISE/EXIGE/EUROPA/2-ELEVEN
V.I.N. SCC??????????????????

Dear Mr/Ms. Customer,

This letter concerns an important safety measure affecting your Lotus, and asks you to arrange with your dealer for a precautionary safety check to be carried out.

On a small range of vehicles, including your own, it has been found that the bolts securing the rear hubs to the suspension may not have been correctly tightened. **THERE IS A DANGER THAT INCORRECTLY TIGHTENED BOLTS MAY RESULT IN AN INSECURE REAR WHEEL HUB, LEADING TO A LOSS OF VEHICLE CONTROL.** Lotus is instituting a vehicle recall campaign in order to ensure that all affected cars are checked, and where necessary, rectified. To minimise any risk, it is recommended that this work be performed as soon as possible.

Lotus sales or dealer records, or data provided by vehicle licensing authorities, indicate that you are the registered keeper of the Lotus model with V.I.N. (Vehicle Identification Number) quoted above.

If you are no longer the owner or keeper of this vehicle, please help us by e-mailing CustomerServices@LotusCars.co.uk to advise details of the new owner. Alternatively, telephone +44 (0)1953 608844. Your co-operation in this matter would be very much appreciated. Thank you.

The necessary work will be carried out entirely free of charge, and should take approximately 30 minutes to complete. Please contact your preferred Lotus dealer to arrange an appointment to have this work performed at your earliest convenience. Any authorised Lotus dealer will be pleased to carry out this work, but if you should have any queries or concerns, please telephone Customer Services for assistance: +44 (0)1953 608844. Alternatively, e-mail: CustomerServices@LotusCars.co.uk

May we apologise for any inconvenience caused, and assure you that your safety is always our primary concern.

This recall is carried out under the terms of the U.K. Code of Practice on Vehicle Safety Defects and with the authority of the U.K. Vehicle & Operator Services Agency.

Yours sincerely,



Neil Lovelock - Aftersales Manager